



TBi XCT 200W

Vodeno hlađenje
 100% (10 min.)
 AC: 175A
 DC: 250A
 Ø 1.6-4.0 mm



TBi XCT 400W

Vodeno hlađenje
 100% (10 min.)
 AC: 315A
 DC: 450A
 Ø 1.6-4.0mm

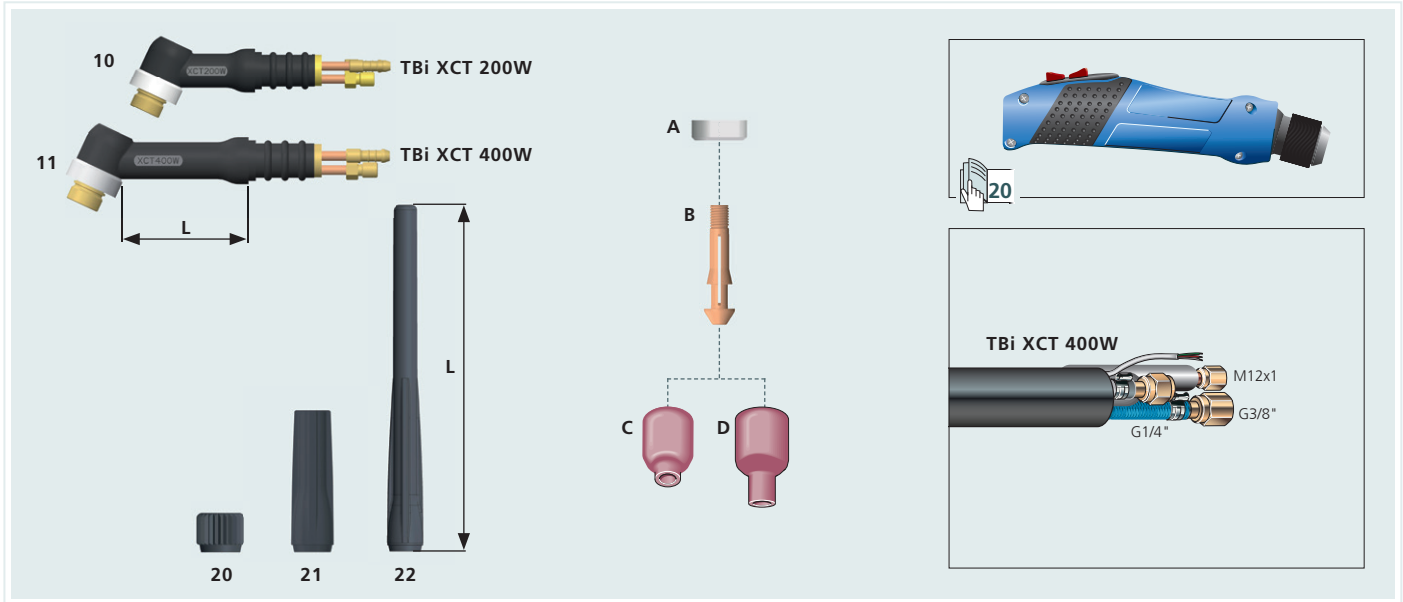

Ersatzteile / Spare parts / Pièces de rechange

10	Tijelo gorionika	XCT 200W	L = 32 mm	405PX20700
11	Tijelo gorionika	XCT 400W	L = 52 mm	405PX40700
20	Kapa	Kratka	L = 13 mm	402PX40600
21	Kapa	Srednje	L = 50 mm	402PX40650
22	Kapa	Duga	L = 145 mm	402PX40700
A	Izolator			401PX40700

	Ø 1.6 mm Ø 1/16"	Ø 2.4 mm Ø 3/32"	Ø 3.2 mm Ø 1/8"	Ø 4.0 mm Ø 5/32"
--	---------------------	---------------------	--------------------	---------------------

Držači Wolfram elektrode

▶ B	L = 44.0 mm	-	-	-	-
		401PX40501	401PX40502	401PX40503	401PX40504

	No. 4 Ø 6.5 mm Ø 1/4"	No. 5 Ø 8.0 mm Ø 5/16"	No. 6 Ø 9.5 mm Ø 3/8"	No. 7 Ø 11 mm Ø 7/16"	No. 8 Ø 12.5 mm Ø 1/2"	No. 10 Ø 16 mm Ø 5/8"
--	-----------------------------	------------------------------	-----------------------------	-----------------------------	------------------------------	-----------------------------

Keramičke sapnice

▶ C	L = 25.5 mm	53N58 401P201400	53N59 401P201401	53N60 401P201402	53N61 401P201403	53N61S 401P201404	- 401P201409
▶ D	L, L = 35.0 mm	53N58L 401P201408	53N59L 401P201405	53N60L 401P201406	53N61L 401P201407	-	- 401P201410

▶ = Standard